

MOTOR DATA SHEET DS_SPM_07/22

GENERAL CHARACTERISTICS

Frame size	IEC72-1	63
Type of construction	IEC34-7	B14
Weight [kg]		9.5
Moment of Inertia [10 ⁻⁴ kgm ²]	Jo	0.0014
Degree of protection	IEC34-5	IP69K
Direction of rotation	Both	
Method of cooling	IEC34-6	IC410
Duty	IEC34-1	S1
Insulation class	IEC34-1	F
Ambient temperature [°C]	-15/+40	
Dielectric Strength Test	IEC34-1 2kV 1 s	

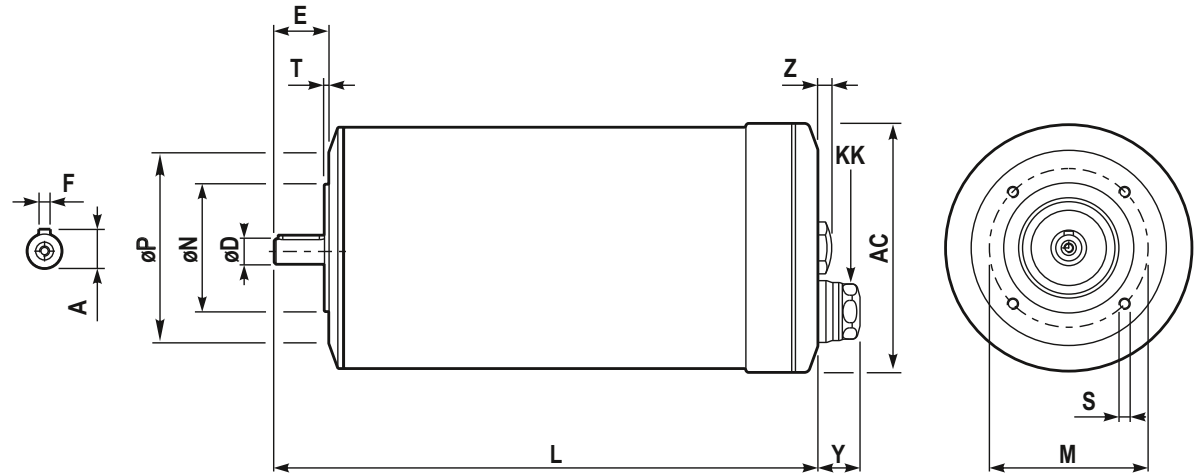

NAMEPLATE DATA and CONNECTION DIAGRAM

PREMIUM MOTOR S.S.316L
3~ SPM71A4 IMB14

Ins.Cl.F Amb. max 40°C IC410 Duty S1 IP69K
 DE 6203.2Z NDE 6203.2Z Weight 9.5 Kg

Hz 50 Δ/Y 230/400V Hz 60 Δ/Y 277/480V
 0.12 kW 0.7 / 0.4 A 0.16 HP 0.7 / 0.4 A
 1448 min⁻¹ cosφ 0.68 1755 min⁻¹ PF. 62 %

EFF(100%) 75 % NEMA DES.- CODE K

INVERTER DUTY

PWM SPEED RANGE 2.5:1: CT / 10:1 VT

Acceptable for field wiring

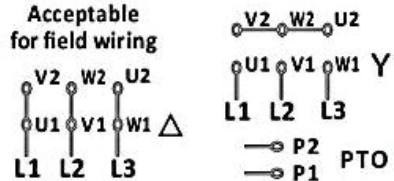

INVERTER DUTY
WASHDOWN
HYGIENIC
S.S. 316L
IP69K

DIMENSIONS

AC	Ø 133	M	Ø 75
Y	22.5	ØN	Ø 60
L	247.5	ØP	Ø 90
ØD	11 j6 M4	T	2.5
E	23	n x S	4 M5 x 13
F	4	Z	7.4
A	12.5	KK ⁽¹⁾	M20x1.5 cable gland: clamping range Ø9-12 mm

BEARINGS

DE	6203.2Z
NDE	6203.2Z

(1) Hygienic cablegland, EHEDG certified
 Stainless steel, IP69K

SPECIAL EXECUTION AND ACCESSORIES

	code
-	
-	
-	